

• Terminal Type

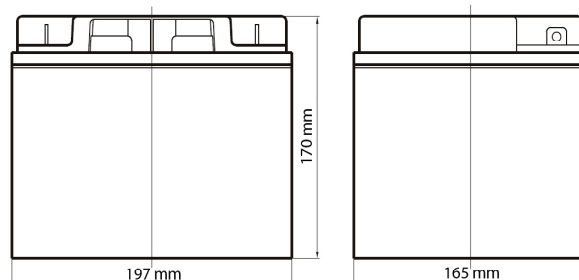
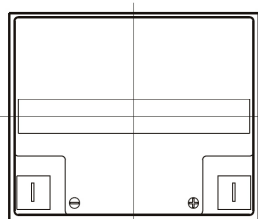
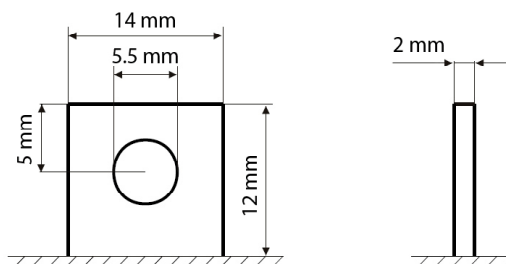

• Specifications

Battery Model	UL 40-12			
Designed Floating Life	8 Years			
Capacity (25°C)	20HR (2.0A, 1.75V)	10HR (3.8A, 1.75V)	5HR (6.8A, 1.75V)	1HR (24A, 1.75V)
	40 AH	38 AH	34 AH	24 AH
Dimensions	Length	Width	Height	Total Height
	197 mm	165 mm	170 mm	170 mm
Approximate Weight	13.5 kg			
Internal Resistance	Fully charged at 25°C: 0.0095 Ohm			
Self Discharge	3% of capacity declined per month at 25°C			
Capacity Affected by Temperature (20HR)	40°C	25°C	0°C	-15°C
	102%	100%	85%	65%
Charge Voltage (25°C)	Cycle use		Float use	
	14.4-14.8V (-30mV/°C), max. Current: 10A		13.6-13.8 (-20mV/°C)	

• Construction

- Component - Raw material
- Positive - Lead dioxide
- Negative - Lead
- Container - ABS
- Cover - ABS
- Sealant - Epoxy Resin
- Safety valve - EPDR
- Terminal - Copper
- Separator - Fibre glass
- Electrolyte - Sulphuric acid
- ABS containers and covers - Flame Retardant optional
- Sealed and maintenance free option
- Non-spillable construction design

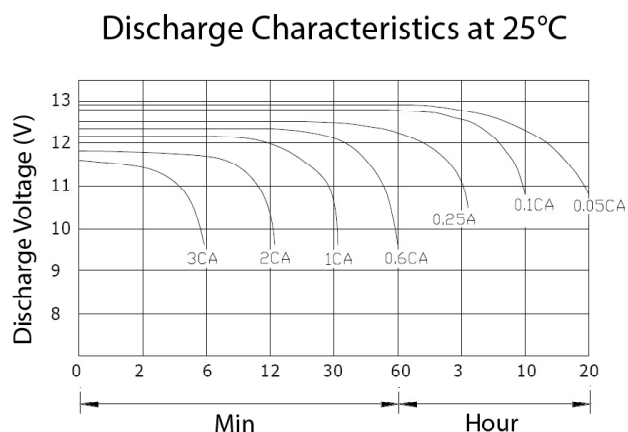
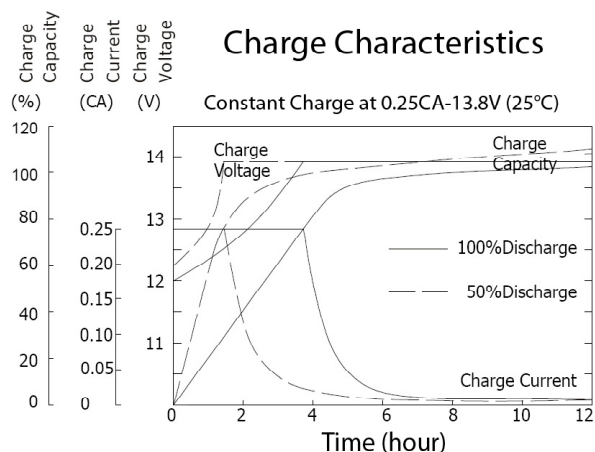

Relationship of OCV and the state of charge

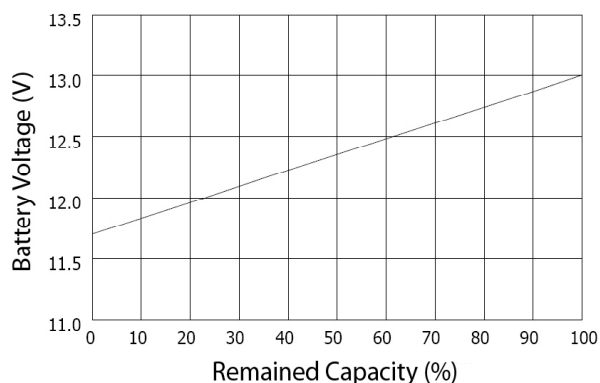

Self Discharge Characteristics

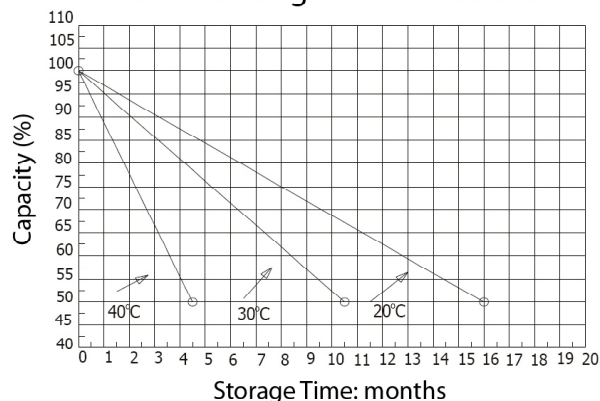

- Constant Current discharge ratings - amperes at 25°C**

F.V / Time	5 MIN	10 MIN	15 MIN	30 MIN	1 HR	3 HR	5 HR	10 HR	20 HR
1.60 V	157.6	96.8	73.36	44.72	24.4	12.4	7.36	4.08	2.24
1.67 V	146.4	92.8	71.12	42.88	23.7	10.6	7.20	4.00	2.18
1.70 V	135.2	88.8	68.88	38.88	22.9	10.5	7.04	3.92	2.16
1.75 V	133.6	86.4	66.64	37.04	22.4	9.76	6.84	3.87	2.09
1.80 V	118.4	82.4	60.56	34.32	20.9	9.52	6.72	3.84	2.08
1.85 V	104.8	78.2	54.24	31.44	20.2	9.36	6.71	2.96	2.08

- Constant Power discharge ratings - watts at 25°C**

F.V / Time	5 MIN	10 MIN	15 MIN	30 MIN	1 HR	3 HR	5 HR	10 HR	20 HR
1.60 V	320.0	208.0	160.0	92.8	52.0	20.2	13.8	7.76	4.08
1.67 V	309.6	203.2	157.6	91.2	51.4	20.2	13.7	7.76	4.08
1.70 V	296.8	200.0	153.6	89.6	50.9	20.0	13.7	7.68	4.00
1.75 V	279.2	192.0	148.8	87.2	50.1	19.8	13.6	7.68	4.00
1.80 V	242.4	177.6	142.4	84.8	48.5	19.4	13.4	7.52	3.92
1.85 V	228.8	164.8	136.0	80.8	47.4	19.1	13.3	7.52	3.92